



ANNIE'S TOY

2005 LAGOON

38ft

Basics

Manufacturer:	LAGOON
Model:	Lagoon 380
Year Built:	2005
Model Year:	2005
Type of Yacht:	Sail
Price:	\$269,000
Condition:	Used
Status:	Available for Sale
Listing Date:	9/1/2009

Annie's Toy" is an owner's version 3 cabin/2 head Lagoon 380 in the desirable S2 (second series) version.

Location

Location:	Tortola, British Virgin Islands
Marina Name:	Village Cay

Hull and Deck Configuration

Hull Material:	Fiberglass
Hull Configuration:	Catamaran

Dimensions & Specifications

Manuf. Length:	38
Draft:	3'9"
Beam:	21'5"
Staterooms:	3
Heads:	2
Sail Area:	527
LWL:	36'1
Mast Height Clearance:	56'10"
Berths:	0
Holding Tank:	0
Max # of Guests:	6
Refit Year:	

Approximate Capacities and Speeds (Knots)

Fuel Capacity:	52
Water Capacity:	86
Approx. Cruise Speed:	0
Approx. Max Speed:	0

Weight

Displacement:	1600
----------------------	------

WORLDWIDE SEARCH TOOLS

Can't find the catamaran, multihull or boat you want above? Click below to use our worldwide search tools. [Search Sailing Catamarans for Sale & Multihulls](#)

Engines

	Manufacturer	Model	Engine Fuel Type	H.P.	Engine Type	Year	Approx. Hours
#1	Yanmar	Yanmar 3YM30 SD	Diesel	29	Inboard	2005	2050
#2	Yanmar	Yanmar 3YM30 SD	Diesel	29	Inboard	2005	2050

Boat Highlights

Annie's Toy" is an owner's version 3 cabin/2 head Lagoon 380 in the desirable S2 (second series) version. This catamaran for sale has the upgraded 30 HP Yanmars, an additional water tank, (2) solar panels, Raymarine wind, depth and autopilot, Xantrex Inverter/charger, 200ft of 10mm galvanized chain on the main Delta and new trampoline.

All lines lead to helm for easy sailing. She has been constantly maintained/ updated and presently lies in the British Virgin Islands, so you can begin your travels in the beautiful waters of the Caribbean!

Layout & Accommodations

Owner's version 3 cabin/2 heads. The starboard hull is dedicated exclusively to the owner, featuring a sliding privacy door, queen-sized bed, desk, bookshelves, closet, and a private head with separate large enclosed shower.

Guest cabins each have a double berth, storage and share dual access head area midships.

Headroom:

Owner's stateroom – 6'5"

Fwd Guest cabin – 6'7"

Aft Guest cabin – 6'1"

Port head – 6'3"

From the salon you can enjoy a 360° view through the windows and the sliding glass doors. The chart table is directly accessible from the cockpit. Fans in cabins and salon.



Layout

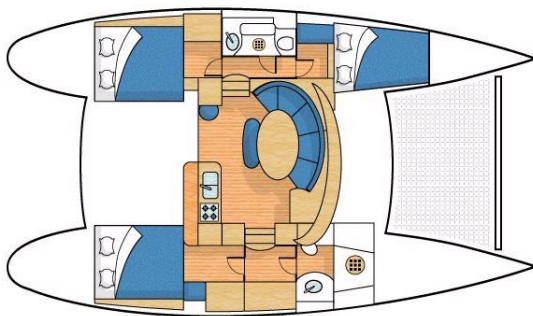

Lagoon layout



Lagoon salon and galley



Lagoon accommodations



Lagoon accommodations

Galley

Galley UP and located between the salon and the cockpit, with a wooden counter serving as a sideboard for the cockpit table as well as a bar for the salon. The S2 galley offers plenty of counter space storage.

- 12V Upgraded refrigerator, water cooled
- Isotherm Cruise 90 Freezer (4 drawers), located in Cockpit under helm
- Microwave
- Three-burner Propane Stove with oven
- Corian drainboard, fits over stove area

Deck & Equipment

- Blue canvas bimini
- Bow pulpit seat
- Large, self-draining cockpit, functional as deck salon, with varnished wood cockpit table
- Storage locker in cockpit seat
- Steering station on roof bulkhead
- Glass rudders and shafts
- Emergency tiller
- Direct access to water, port side
- Deck shower on port side
- Freshwater dock inlet
- Stainless steel swim ladder on port side
- Rubber transom rub rails
- Delta main anchor with 200ft of 10mm galvanized chain
- Brittany 2nd anchor (originally the main anchor) with approximately 60ft chain and 140ft line
- New trampoline mid 2009
- Dinghy davits
- Liferaft

Electronics & Navigation

- Raymarine navigation pkg: wind, depth, speed, autopilot
- Shipmate VHF
- Battery monitor
- Radio/CD
- Waterproof speakers in cockpit

Electronics, Power, & Plumbing

- Xantrex Inverter/charger

- (2) Solar panels on dinghy davits
 - Upgraded alternator
 - (2) Extra 4D batteries in addition to standard
 - Optional extra water tank added
-

Engine & Mechanical

- Upgraded: (2) Yanmar 29 HP diesel engines, approx 2050 hrs.
 - Dual lever engine control at helm station
 - Soundproof engine compartments
 - Cable steering system
-

Sails & Rigging

- 1-roached mainsail: 505 sq. ft and battens
 - 1 furling Genoa, sail area 333 sq.ft
 - 1 Genoa halyard
 - 1 mainsail sheet and traveler in aft cockpit
 - 2 Genoa sheets
 - 2 Genoa tracks with Genoa car
 - 2 Genoa cars with adjustable fairleads
 - 2 roof winches, 40.2 ST
 - 1-mainsail reef lines
 - 1 mainsail outhaul
 - 1 mainsail topping lift
 - 1 Genoa furling line
 - Lazy jacks
 - 2-winch handle
 - 2 winch handle holders in cockpit
 - 6 mooring cleats
 - 1200 KW electric anchor windlass in anchor locker
-

Additional Information

“Annie’s Toy” is hull#322 and is the desirable S2 (second series) version. Lagoon updated the L380 second series versions with the following upgrades:

Large one-way hull windows in cabins (same as the Lagoon 440) for improved natural lighting, Harken winches and deck gear, new galley with more counter space/storage, separate stove top and upgraded oven, new navigation station with more space for equipment, new owner's cabin with privacy door and more room, new bench seat in cockpit alongside the bulkhead with integrated cooler, versatile salon and cockpit table arrangement that allows for interchangeability, new steering position with larger console and double seat, additional winch for halyards on port for ease of sail handling.

Constant maintenance on “Annie’s Toy” has changed many original items with original Lagoon parts or better by a professional. The main changes have been (2) solar panels added on dinghy davits, Xantrex Inverter/charger, 200ft of 10mm galvanized chain on the main anchor, Delta main anchor, and new trampoline added mid 2009.

Disclaimer

The Company offers the details of this vessel in good faith but cannot guarantee or warrant the accuracy of this information nor warrant the condition of the vessel. A buyer should instruct his agents, or his surveyors to investigate such details as the buyer desired validated. This vessel is offered subject to prior sale, price change, or withdrawal without notice.
